

Hobie Bravo Parts Guide

Hull and Sail

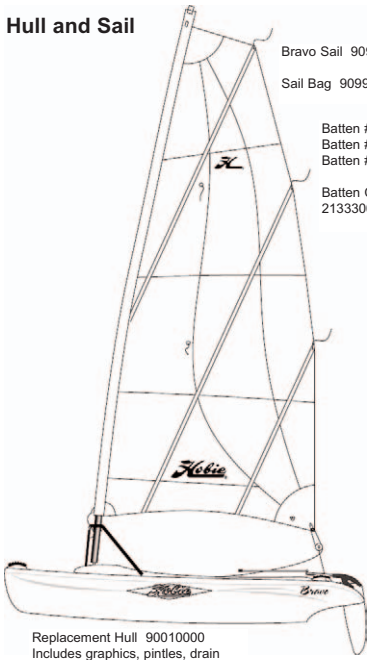

- Bravo Sail 90990000
- Sail Bag 90992000
- Batten #1 (4'7") 91011011
- Batten #2 (11'9") 91021111
- Batten #3 (5' 8") 91031011
- Batten Cap 21333000

Replacement Hull 90010000
Includes graphics, pintles, drain plugs, handles, hatches, and hiking straps

Mast Ball

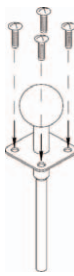

- Mast Ball 90640021
- Mast Step 90170011
- Screws (5) 8032011

- Hiking Pads 90440010
- Hiking Strap Webbing 8001850 (9'3")
- Strap Adjuster 90440020

- Rear Hatch 71100
- Back-Up Ring 71171
- Rear Gasket 71320
- Screw 8030261 (6)

- Righting Block Screws 8030071

- Drain Plug w/ gasket 10091000 (2)

- Upper Pintle 90880111
- Screw 8030410(2)
- Lower Pintle 90880121
- Screw 8030410 (4)

- Handle 71190
- Screw 8030201 (2)

- FWD Hatch 71140
- FWD Hatch Gasket 71331
- Screws 8031130

Vertical Support (A-Frame)

Vertical Support Assy 90710000

- A-frame Connector 90501031
- Furler Strap w/ Clip 90501036
- Washer 8080551
- Rivet 8030181

- V-support Base IMFR601
- Screw 8030380

A-Frame

A-frame 90711000

Screw 803XXXX

Mast Keeper Knob 90502031

Padeye 71220
Camcleat 37380001

Hinge/Gate Assy 90500021
Screw 80301130

Call your Hobie Dealer to get the proper A-frame attachment kit.

Mainsheet System

Hook 38670011

Block 90700121

Mainsheet Line RM516BLU (28 1/2')

Lower Block 90700111

Nut 8050110

Low Pro Nut 8050100

Mainsheet attachment assembly 90701000

Righting Line

Cheek Block H233

Bungee Cord RS014BLK (7')

Single Block 90440050

Righting Line RL012BLU (10' 9')

Mast Float

Bravo Mast Float 90600011

Mast Float Attachment Strap and Saddle 90600040
Screw 8030071

Mast

Comptip 90611001

Lower Mast 90613000

Eyelet Posts (2) 41220001

Mast Collars (3) 90610101
Delrin Balls (48) 90610111
Mast Bearing 90612111

Furler Line 3/16" x 9'

Mast Base 90640011
Screw 8031151

Rudder

*= sub assembly part included with casting.

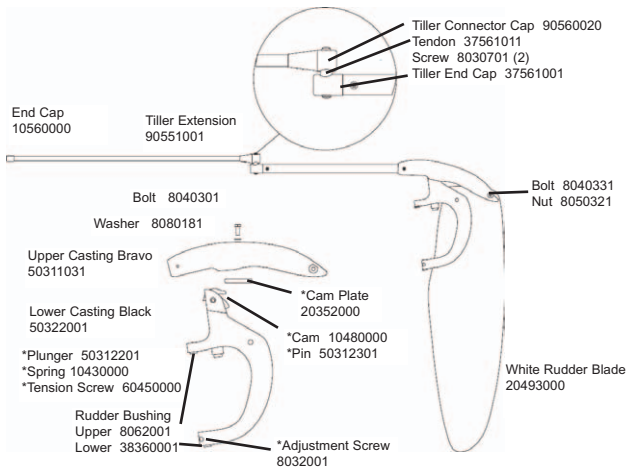

- Tiller Connector Cap 90560020
- Tendon 37561011
- Screw 8030701 (2)
- Tiller End Cap 37561001

End Cap 10560000

Tiller Extension 90551001

Bolt 8040301

Washer 8080181

Upper Casting Bravo 50311031

Lower Casting Black 50322001

*Plunger 50312201

*Spring 10430000

*Tension Screw 60450000

Rudder Bushing Upper 8062001

Lower 38360001

*Cam Plate 20352000

*Cam 10480000

*Pin 50312301

*Adjustment Screw 8032001

White Rudder Blade 20493000

Bravo Rivet Guide

() Indicates quantity need to fasten part

- Mast**
- Comptip Notch 8010181(1)
 - Collars 8010131 (4/collar)
 - Eyelet Posts 8011231 (1/post)

- A-Frame**
- Gate Hinge 8012062 (1)
 - Padeye 8010131 (2)
 - Cam Cleat 8010131 (2)

- Vertical Support Tube**
- Base 8010181 (4)
 - Webbing Strap 8010181 (2)
 - A-frame Connector 8010131 (2)

- Rudder**
- Upper Casting 8010131 (3)
 - Tiller End Cap 8010131 (2)
 - Bravo Extension Cap 8010181 (1)

- Boom**
- End Cap 57130000(2)
 - Boom Cap Casting 8010131 (2)
 - Padeyes 8010131 (2/padeye)
 - Cam Cleat 8010131 (2)